

# 10° TITANIUM VALVE SPRING RETAINERS

Engine Pro titanium valve spring retainers are engineered to perform under the most extreme conditions and are inspected to ensure precise tolerances.

- Manufactured from 6AL4V titanium alloy
- Made in the USA - your assurance of quality
- Light weight
- Machined and polished finish
- Call for other sizes and applications

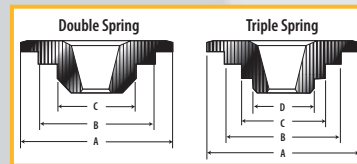

PART #	SPRING O.D.	SPRING TYPE	VALVE STEM SIZE	A	B	C	D
03-1730-16	1.437 / 1.500	DOUBLE	ALL	1.437	1.065	.700	
03-1731-16	1.500 / 1.550	DOUBLE	ALL	1.437	1.100	.800	
03-1732-16	1.500 / 1.550	DOUBLE	ALL	1.500	1.110	.710	
03-1733-16	1.625	DOUBLE	ALL	1.500	1.180	.765	
03-1736-16	1.500 / 1.550	TRIPLE	ALL	1.500	1.135	.835	.635
03-1739-16	1.625	TRIPLE	ALL	1.500	1.180	.870	.635
03-1735-16*	1.625	TRIPLE	ALL	1.500	1.180	.870	.635
03-1794-16	1.300	BEEHIVE	ALL	1.050	.640		

\*+.050 INSTALLED HEIGHT OVER # 03-1739

# STEEL VALVE SPRING RETAINERS

Engine Pro chrome moly steel retainers are designed to handle high pressures developed by new large diameter valve springs. Our retainers are manufactured to precise tolerances to ensure the springs are located properly. Available for 7 degree and 10 degree valve locks.

- 4140 chrome moly steel alloy
- CNC machined
- Heat treated
- Black oxide finish

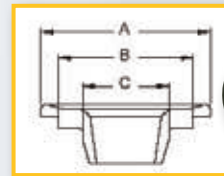

PART #	SPRING O.D.	SPRING HEIGHT	KEEPER DEGREE	VALVE STEM SIZE	DIMENSIONS		
					A	B	C
03-1000-16	1.250	STD	7	11/32"	1.245	.865	.680
03-1001-16	1.250	+.050	7	11/32"	1.245	.865	.680
<b>03-1017-16</b>	<b>1.275/1.325</b>	<b>STD</b>	<b>7</b>	<b>8mm</b>	<b>1.240</b>	<b>.940</b>	<b>.640</b>
03-1003-16	1.437/1.550	STD	7	11/32"	1.440	1.050	.700
03-1002-16	1.437/1.550	STD	10	ALL	1.440	1.050	.700
03-1005-16	1.437/1.550	STD	7	3/8"	1.440	1.050	.700
03-1006-16	1.437/1.500	STD	10	ALL	1.400	1.060	.690
<b>03-1004-16</b>	<b>1.500/1.550</b>	<b>STD</b>	<b>10</b>	<b>ALL</b>	<b>1.437</b>	<b>1.100</b>	<b>.800</b>
03-1007-16	1.500/1.550	+.100	10	ALL	1.500	1.115	.690
03-1008-16	1.550	+.100	10	ALL	1.500	1.105	.710
03-1009-16	1.550	+.100	10	ALL	1.500	1.120	.705
03-1010-16	1.437/1.550	+.100	7	11/32"	1.440	1.050	.700
03-1011-16	1.055	STD	7	8mm	1.030	0.640	BEEHIVE
03-1012-16	.959	STD	7	STOCK	0.930	0.630	BEEHIVE
03-1013-16	1.055	STD	7	11/32"	1.030	0.640	BEEHIVE
03-1014-16	1.095	STD	10	ALL	1.050	0.640	BEEHIVE
03-1015-16 *	1.055	STD	7	8mm	1.030	0.640	BEEHIVE
<b>03-1016-16</b>	<b>1.437/1.500</b>	<b>STD</b>	<b>7</b>	<b>11/32"</b>	<b>1.400</b>	<b>1.030</b>	<b>.690</b>

\* SAME AS 03-1011 BUT I.D. IS MACHINED FOR ADDITIONAL VALVE GUIDE CLEARANCE.

# LASH CAPS

In extreme performance and racing conditions, lash caps are necessary to protect the valve tip from pounding caused by an engine running on the edge of valve float. Lash caps must be used with titanium valves.

- CNC Machined From Hardened 8620 Steel
- Finish Lapped to Insure a Parallel Plane
- EDM Oil Hole Prevents Friction Welding of Cap to Valve
- Black Oxide Finish / Made In The USA

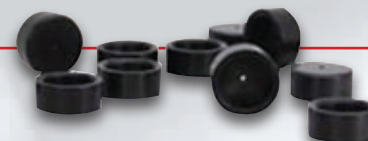

PART #	DESCRIPTION	OVERALL HEAD HEIGHT	THICKNESS	VALVE STEM SIZE
04-1620-16	HARDENED LASH CAP	.230	.080	5/16"
04-1621-16	HARDENED LASH CAP	.210	.080	11/32"
04-1622-16	HARDENED LASH CAP	.190	.080	3/8"